

← COMMON AREA →

S 40° - 38' E  
16.00'

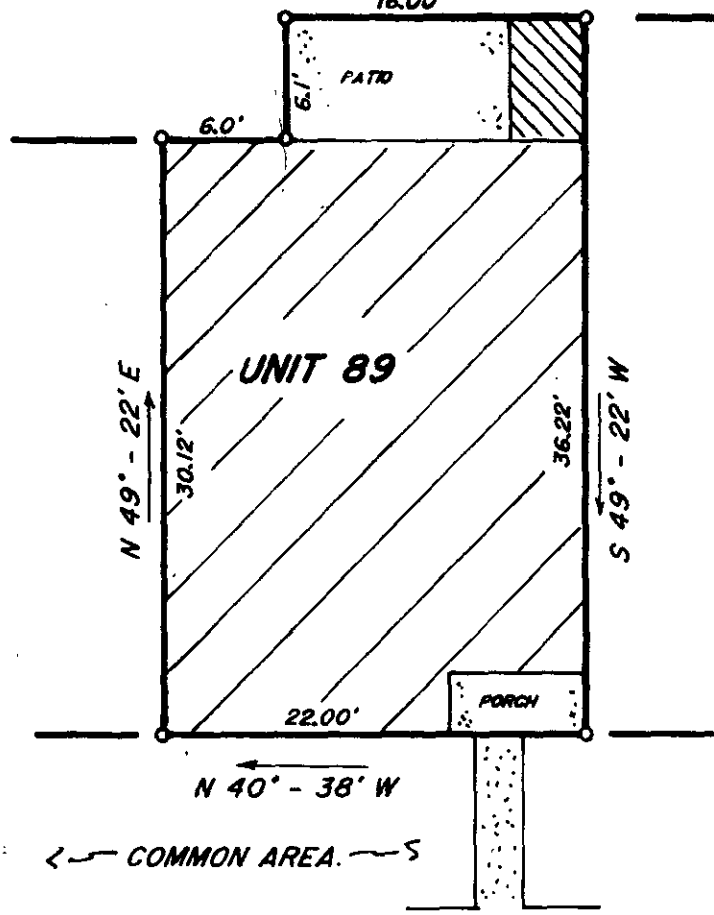

UNIT 90

UNIT 88

← COMMON AREA →

FILED  
GREENVILLE CO. S.C.  
JAN 13 11 29 AM '86  
DUNNIE S. TANKERSLEY  
R.M.C.

23079

12-G-97

This is to certify that on December 27, 1985, I surveyed the property shown on this plat, known as Unit 89 on plat of Furman Place Residences, recorded in the R.M.C. Office of Greenville County, in Plat Book \_\_\_\_\_ at Page \_\_\_\_\_, and that the property lines, walls and buildings are as shown hereon, that the building located on said lot does not encroach or project on adjacent streets or property, and that no adjacent walls or buildings encroach or project on said premises, and that no utility R/W's cross this property, except as shown hereon. According to the Flood Rate Insurance Map and to the best of my knowledge, this structure is not in an Established Flood Zone.

*Fredrick E. Landrith*  
 Fredrick E. Landrith, R.L.S. 9545

THIS PROPERTY IS SUBJECT TO ANY AND ALL RIGHTS OF WAY AND EASEMENTS OF RECORD.

**LANDRITH SURVEYING**  
 Land Surveyors - Topographical Maps  
 Construction Layout  
 628-C WADE HAMPTON BLVD.  
 GREENVILLE, S.C. 29609  
 (803) 271-8536

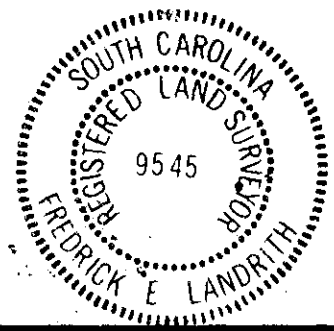
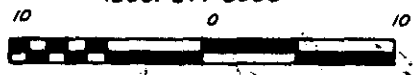

STATE of SOUTH CAROLINA  
 COUNTY of GREENVILLE

**FURMAN PLACE**  
 BUILDING "B", UNIT 89  
 SURVEY FOR

**CHARLEEN G. FERGUSON**

SURVEYED BY	FEL	CHK'D BY	TLM
DRAWN BY	TLM	DATE	12/27/85

SEAL

PROJECT NO. 85-518